

PIN	1	2	3	4	5	6	7	8	9	10	11	12	13	14	15	16	17	18	19	20	21	22	23	24	25	26	27	28	29	30	31	32	33	34	35	36
COM1	1a	2a	3a	4a	5a	6a	7a	8a	ER	V	k2	COM1	k1											8f	7f	6f	5f	4f	3f	2f	1f					
COM2	1b	2b	3b	4b	5b	6b	7b	8b	KR	A	W	COM2												8g	7g	6g	5g	4g	3g	2g	1g					
COM3	1c	2c	3c	4c	5c	6c	7c	8c	r			COM3												8e	7e	6e	5e	4e	3e	2e	1e					
COM4	1h	2h	3h	4h	5h	6h	7h	8h	h1	h2		COM4												8d	T4	T3	6d	T2	5d	T1	4d	3d	2d	1d		

NOTES:

- VIEWING ANGLE: 6:00 O'CLOCK
- DISPLAY MODE: POSITIVE/REFLECTIVE/TN TYPE
- DRIVING VOLTAGE: 2.5V TO 3.6V, DUTY: 1/4, BIAS: 1/3
- OPERATING TEMP.: -20° C TO 80° C
- STORAGE TEMP.: -25° C TO 85° C
- CONNECTOR: PIN
- THERE ARE CROSSING POINTS IN THE VIEW

6					
5					
4	MODIFY PIN'S DIMENSION	2004.09.25	ZYS		
3	CHANGE DISPLAY MODE	2002.11.14	L.J.Q		
2	CHANGE ADD DIMENSION	2002.8.27	L.J.Q		
1	MODIFY PIN&APPEND DIMENSION	09/08-02	SUN, R.L./L.H.B		

VER.	MODIFY CONTENTS	DATE	DESIGN	APP	BY

XIAMEN OCULAR LCD DEVICES CO., LTD	
GD-2382WP	PART NO.
12/08-02	CHECKED BY
CUSTOMER: QZD	DATE

TECHNICAL SPECIFICATIONS: X: 40.00 Y: 58.00 H: 1.10	APPLICATION: <input type="checkbox"/> Instrument <input type="checkbox"/> Medical <input type="checkbox"/> Navigation <input type="checkbox"/> Other
REVISIONS: NO. 1 DATE: 12/08-02 BY: SUN, R.L./L.H.B	APPROVAL: <input type="checkbox"/> Design <input type="checkbox"/> Drawing <input type="checkbox"/> Assembly <input type="checkbox"/> Test

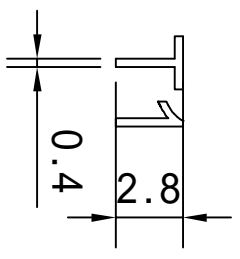
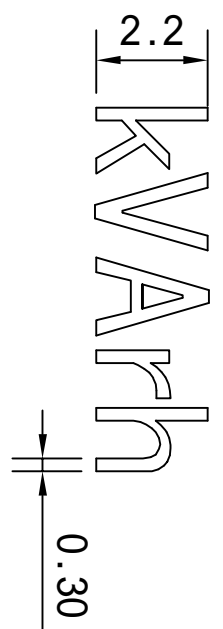
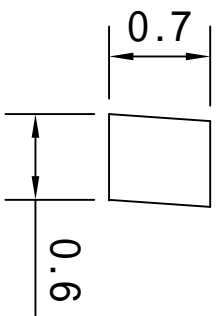
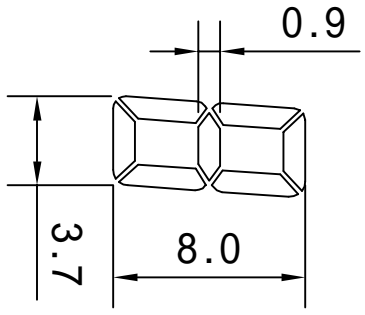
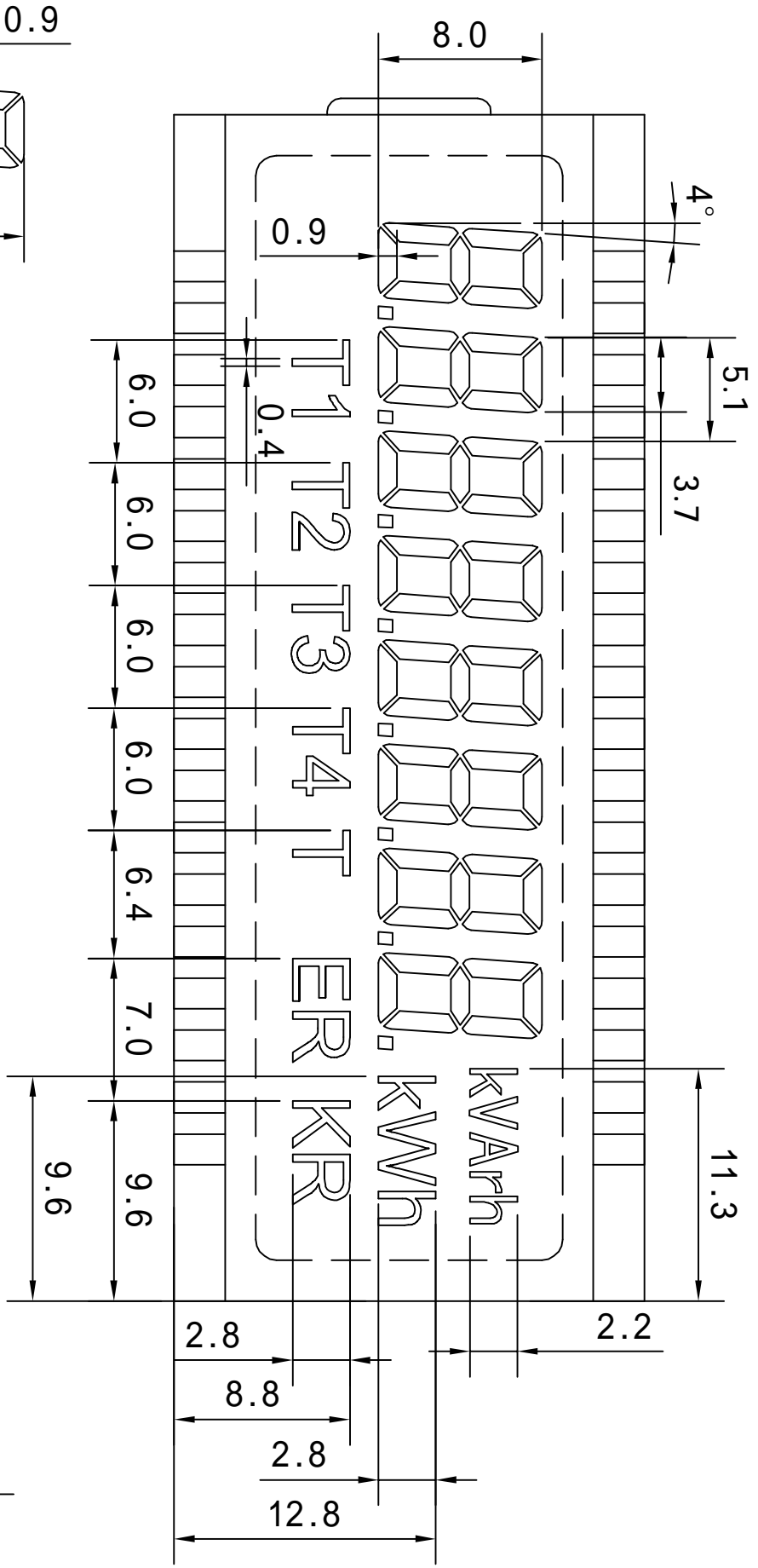

6												
5												
4	MODIFY PIN'S DIMENSION	2004.08.26	ZYS	PART NO.	GD-2382WP	TO CHANGE UNLESS OTHERWISE STATED	X 4.0 2.0	ANGLE: 3.1°	APPLICATION:	<input type="checkbox"/> Instrument	<input type="checkbox"/> Medical Equipment	<input type="checkbox"/> Microdot
3	CHANGE DISPLAY MODE	2002.11.14	L.J.Q	DESIGN BY	SUN, R.L./L.H.B	ALL DIMENSIONS IN MM	1.5 4.0 1.0	UNLESS OTHERWISE STATED	<input type="checkbox"/> Display	<input type="checkbox"/> Accessible	<input type="checkbox"/> Other	
2	CHANGE ADD DIMENSION	2002.8.27	L.J.Q	CHECKED BY		CUSTOMER: QZD			<input type="checkbox"/> Draw Not Invented	<input type="checkbox"/> Air-condition	<input type="checkbox"/> No	
1	MODIFY PIN&APPEND DIMENSION	15/08-02	SUN, R.L	APP					<input type="checkbox"/> Change	<input type="checkbox"/> X-step	<input type="checkbox"/> No	
VER.	MODIFY CONTENTS	DATE	DESIGN	DESIGN								

 XIAMEN OCULAR LCD DEVICES CO., LTD