

Front view

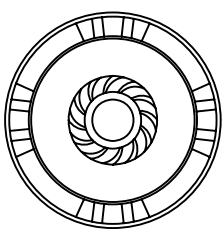
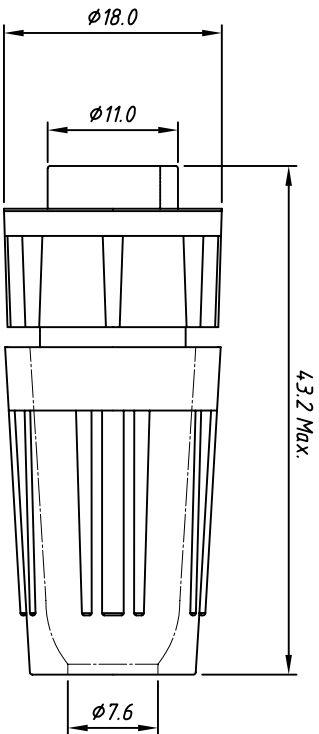

Back view

Order information

L-KLS15-249-XX F1

L: RoHS
 XX: Number of Contacts
 F1: Female Type, Quick Lock

| No. | Solder inter diamte | Contacts resistance Max. |
|-----|---------------------|--------------------------|
| 2 | Ø1.6mm | 6 mΩ |
| 3 | Ø1.6mm | 6 mΩ |
| 4 | Ø1.0mm | 3 mΩ |
| 5 | Ø1.0mm | 3 mΩ |
| 6 | Ø1.0mm | 3 mΩ |
| 7 | Ø1.0mm | 3 mΩ |
| 8 | Ø1.0mm | 3 mΩ |
| 10 | Ø1.0mm | 3 mΩ |
| 12 | Ø1.0mm | 3 mΩ |

Material: Brass, Gold Plated/Silver plated
Contact: PA66+30%GF
Connector Body: PA66+30%GF
Insert Body: PA66+30%GF
Sealing: O-ring
Electrical & Mechanical data
Waterproof Rating: IP67, Mated
Current Rating: 10A
Voltage Rating: 200V
Insulation resistance: 2000 MΩ Min.
Withstanding Voltage: 1500V AC
Cable OD: Ø3.5~6.5mm
Orientation: Straight
Mating Life: 500 cycles Min.
Temperature Range: -40°C ~ +105°C

| GENERAL TOLERANCE | ANGLE TOLERANCE | PROJECTION | | Description: |
|-------------------------------------|-------------------------------|------------|------------|---|
| | | UNITS | SHEET SIZE | |
| X: ±0.60 .X: ±0.38 .XX: ±0.25 | X: ±5° .X: ±3° .XX: ±2° | mm | A4 | IP67 Circular Connectors, Quick lock, Female Plug KLS15-249-xF1 |
| Draw by: Date | | KLS P/N: | | |
| Check by: Date | | SCALE | | |
| SCALE | | SHEET | | OF |

KLS ELECTRONIC CO., LTD.