

# Ordering Code:

CU01 S A H 1 S 00  
 ① ② ③ ④ ⑤ ⑥ ⑦

① Series No.

② S= Socket

③ Plating option:

A= Selective Gold flash plated  
 over 1.27μm(50μ") Nickel

C= Selective 0.76μm(30μ") Gold plated  
 over 1.27μm(50μ") Nickel

④ H= Right angle

⑤ Insulator Color: 1= Black, 0= White

⑥ S= Single port

⑦ Option: 00= Standard

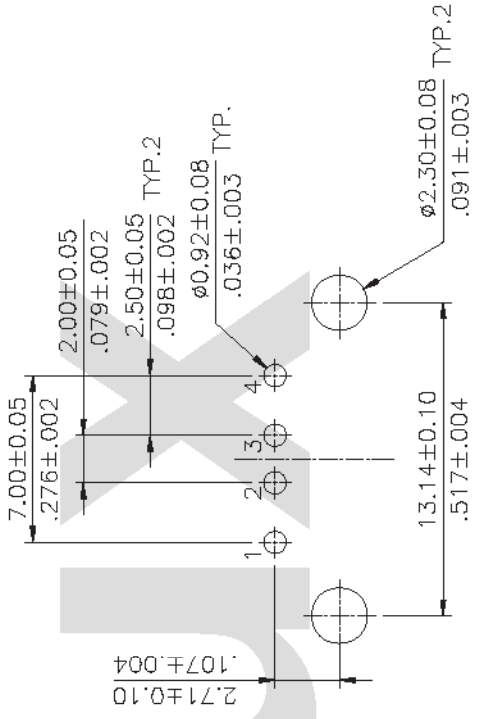
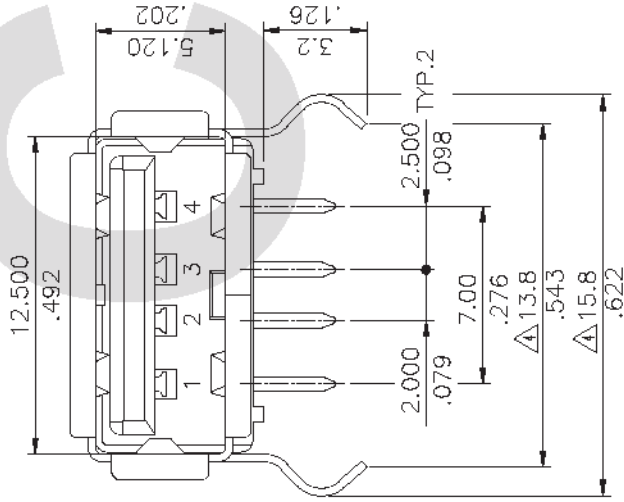
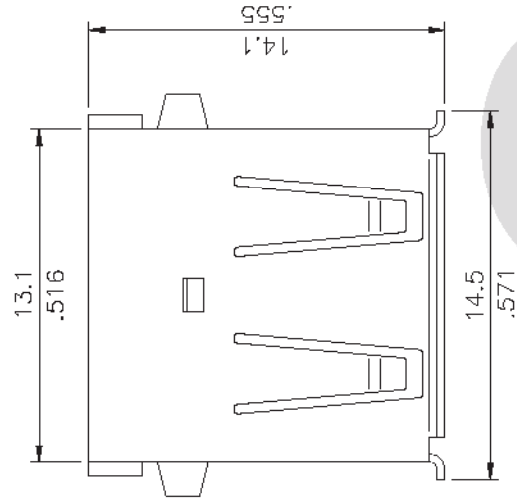

Materials :  
 Insulator: Glass filled polyester UL 94V-0  
 Contacts: Phosphor Bronze  
 Shell: Brass  
 Shell Plating: 80μ" Nickel over 50μ" Cu

Recommended P.C. Board Layout

CVILUX CORP.  
 2006.11.21  
 ISSUED

| SYM | NAME | DATE    | REVISIONS           |
|-----|------|---------|---------------------|
| 4   | Hank | 11/8/06 | ECN06412            |
| 3   | Jim  | 8/22/06 | ECR06070-0/ECN06293 |
| 2   | Jim  | 7/01/05 | ECR05062-0/ECN05231 |
| 1   | Sun  | 7/01/05 | ECR05062-0/ECN05231 |

| DATE    | BY:    | CHKD BY: | APP'D BY: |
|---------|--------|----------|-----------|
| 11/8-06 | Hank   | David    | Alex      |
| 11/9-06 | Eisley | David    | Alex      |
| 11/9-06 | Eisley | David    | Alex      |
| 11/9-06 | Eisley | David    | Alex      |

| UNIT:     | mm / inch                  |
|-----------|----------------------------|
| TOLERANCE | UNLESS OTHERWISE SPECIFIED |
| X         | ± 0.30/.012 X' ± 1"        |
| .XX       | ± 0.20/.008 X' ±           |
| .XXX      | ± 0.10/.004 .XX' ±         |

|           |   |
|-----------|---|
| TITLE:    | U.S.B TYPE A RIGHT ANGLE BOARD MOUNT SOCKET |
| MATERIAL: |   |
| FINISH:   |   |

|                                |       |  |
|--------------------------------|-------|--|
| 瀚菱股份有限公司<br>CvILux Corporation |       | DRAWING NO. CU0101SN<br>PART NO. CU01S**H**S00 |
| SCALE                          | 3 / 1 | SHEET 1 OF 1                                   |

RoHS Compliant