

SPECIFICATIONS
 Rated Current:1.0AMP
 Contact Resistance:20mΩ Max
 Withstand Voltage:500V AC/DC
 Insulation Resistance:1000MΩ Min
 Operation Temperature:-40°C to +105°C

Contact Material:Brass
 Contact Plating:Au or Sn Over Ni
 Insulator Material:Polyester(UL94V-0)
 Standard: PA6T
 Max.Processing Temp: 230°C for 30-60 seconds
 (260°C for 10 seconds)

Recommended P.C.B Layout(Top Side)
 (PCB BOARD TOLERANCE±0.05)

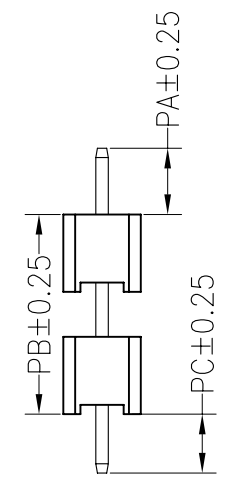
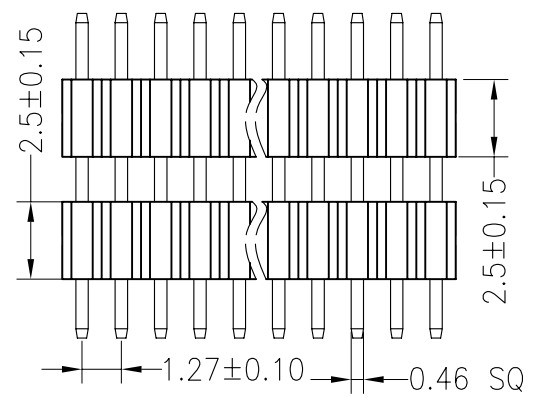
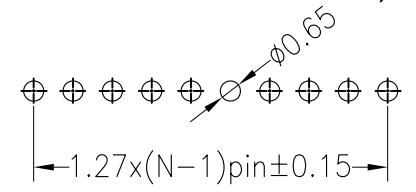
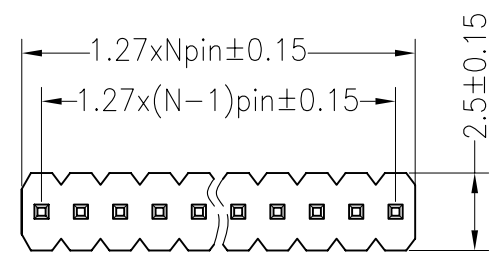

Dimension antitheses list				
ITEM	PA	PC	PB	L
Alternate	2.80	2.60	5.70	11.10

				OPERATION		DRAW	YiYuSheng	12.03.28	SCALE	FIT	KLS ELECTRONIC CO., LTD		
				X.X	±0.30				UNIT	mm			
				X.XX	±0.20	CHECK	SIZE	A4					
A0	2012.03.28	NEW DRAWING		X.XXX	±0.10		SHEET	1/1	PART NO.	L-KLS1-218C-2.5-1-11-S-2.6*2.8*11.1			
REV	DATE	MODIFICATION DESCRIPTION		CHANGE	Angle	±3°	APPROVE	PROJ.	◆	TITLE:	1.27PH H2.5+2.5mm 1xNpin DIP		
					DIM	TOL							