

A

R/A type
WITH EAR TYPE

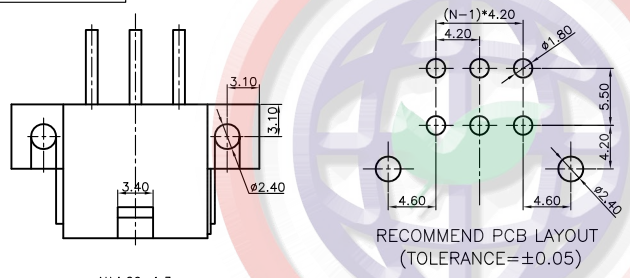

RECOMMEND PCB LAYOUT
(TOLERANCE=±0.05)

V/T type

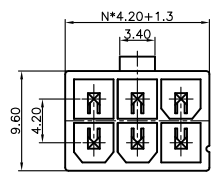

RECOMMEND PCB LAYOUT
(TOLERANCE=±0.05)

REV.	DESCRIPTION	DRAWN	CHECKED	APPROVED
A	NEW RELEASE	YCH 12/15/07'	~	

NOTES:

- MAIN SPECIFICATIONS
 - Housing material: NYLON 66
 - Rated voltage: 250V
 - Rated current: 3A
 - Contact resistance: ≤ 100mΩ
 - Insulation resistance: ≥ 1000MΩ
 - Withstanding voltage: 500V, AC 1 minute
 - Temperature range: -25°C ~ +85°C
 - Recommend PC board thickness: 1.6mm
- PRODUCT NUMBER CODE:

DS1073-01- X X X X X

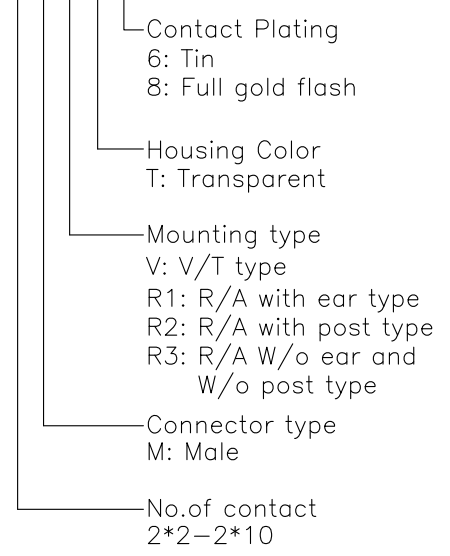

D

R/A type
WITH POST TYPE

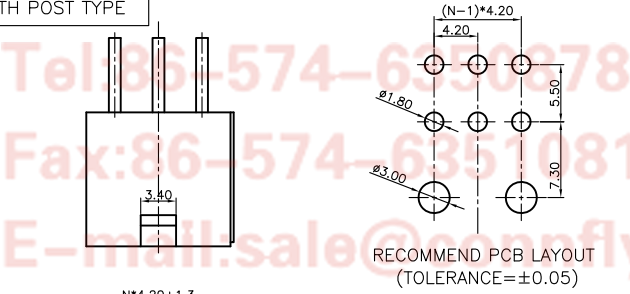

RECOMMEND PCB LAYOUT
(TOLERANCE=±0.05)

R/A type
W/O EAR AND POST TYPE

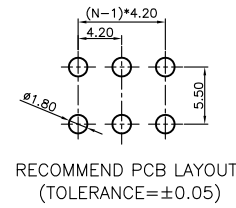
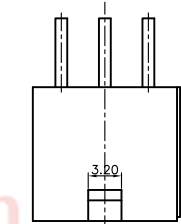

RECOMMEND PCB LAYOUT
(TOLERANCE=±0.05)

E

F

G

H

GENERAL TOLERANCE	ANGLE TOLERANCE	PROJECTION	TITLE	ATX CONNECTOR PITCH 4.2mm
X. ±0.60	X. ±5°	UNITS	mm	DIP & R/A type
.X ±0.38	.X ±3°	SHEET SIZE	A4	SERIES
.XX ±0.25	.XX ±2°			DS1073-01 SERIES
DRAWING TYPE	CUSTOMER	晨翔电子有限公司 CONNFLY CONNFLY ELECTRONIC CO. LTD		
SCALE	1:1 SHEET 1 OF 1			
DRAWING NO.	C-DS1073-01-XXXXX-A			

Tel: 86-574-63502787
 Fax: 86-574-63510817
 E-mail: sale@connfly.com
 http://www.connfly.com
 Add: Industry Zone K
 Xian Cixi Ningbo China
 P.C: 315333