

WIRE WOUND CHIP MOLDED INDUCTORS / WCI TYPE

FEATURES

- ◆ Terminals are highly resistant to pull forces.
- ◆ Very strong solder ability by flow soldering, soldering iron or wave soldering.
- ◆ Highly reliable in environments of sudden temperature change and humidity.
- ◆ Highly accurate dimensions can be mounted automatically.
- ◆ Highly resistant to mechanical shocks and pressure.



APPLICATIONS

- ◆ Video cameras, portable VCRs
- ◆ television tuners, mobile telephones
- ◆ Car radios, car stereos, thin tape radios
- ◆ Microtelevisions, Liquid crystal televisions
- ◆ other electronic devices

ORDERING CODE

WCI 3225 - 2R7 □-N

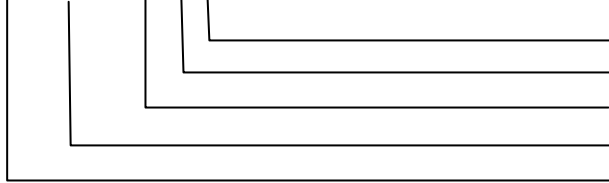

Note: lead-free
 Tolerance (J:±5%, K:±10%, M:±20%)
 Inductance
 Dimension (AxB)
 Product Symbol

DIMENSIONS (UNIT: mm)

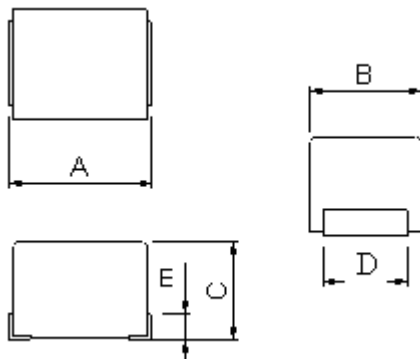

A	3.2 ± 0.3	m/m
B	2.5 ± 0.2	m/m
C	2.2 ± 0.2	m/m
D	1.9 ± 0.1	m/m
E	0.3 (MIN)	m/m



CORE MASTER ENTERPRISE CO., LTD.

<http://www.coremaster.com.tw>

WIRE WOUND CHIP MOLDED INDUCTORS / WCI TYPE

ELECTRICAL CHARACTERISTICS FOR WCI 3225

Part No.	Inductance (uH)	Test Freq. (MHz)	Q Min	Self Resonant FREQ. (MHz) Min	DC Resistance (Ω) Max	Rated Current (mA) Max
WCI 3225-010 □-N	0.010	100	15	2500	0.13	450
WCI 3225-012 □-N	0.012	100	17	2300	0.14	450
WCI 3225-015 □-N	0.015	100	19	2100	0.16	450
WCI 3225-018 □-N	0.018	100	21	1900	0.18	450
WCI 3225-022 □-N	0.022	100	23	1700	0.20	450
WCI 3225-027 □-N	0.027	100	23	1500	0.22	450
WCI 3225-033 □-N	0.033	100	25	1400	0.24	450
WCI 3225-039 □-N	0.039	100	25	1300	0.27	450
WCI 3225-047 □-N	0.047	100	26	1200	0.30	450
WCI 3225-056 □-N	0.056	100	26	1100	0.33	450
WCI 3225-068 □-N	0.068	100	27	1000	0.36	450
WCI 3225-082 □-N	0.082	100	27	900	0.40	450
WCI 3225-R10 □-N	0.100	100	28	700	0.44	450
WCI 3225-R12 □-N	0.120	25.2	30	500	0.22	450
WCI 3225-R15 □-N	0.150	25.2	30	450	0.25	450
WCI 3225-R18 □-N	0.180	25.2	30	400	0.28	450
WCI 3225-R22 □-N	0.220	25.2	30	350	0.32	450
WCI 3225-R27 □-N	0.270	25.2	30	320	0.36	450
WCI 3225-R33 □-N	0.330	25.2	30	300	0.40	450
WCI 3225-R39 □-N	0.390	25.2	30	250	0.45	450
WCI 3225-R47 □-N	0.470	25.2	30	220	0.50	450
WCI 3225-R56 □-N	0.560	25.2	30	180	0.55	450
WCI 3225-R68 □-N	0.680	25.2	30	160	0.60	450
WCI 3225-R82 □-N	0.820	25.2	30	140	0.65	450
WCI 3225-1R0 □-N	1.00	7.96	30	120	0.70	400
WCI 3225-1R2 □-N	1.20	7.96	30	100	0.75	390
WCI 3225-1R5 □-N	1.50	7.96	30	85	0.85	370
WCI 3225-1R8 □-N	1.80	7.96	30	80	0.90	350
WCI 3225-2R2 □-N	2.20	7.96	30	75	1.00	320
WCI 3225-2R7 □-N	2.70	7.96	30	70	1.10	290
WCI 3225-3R3 □-N	3.30	7.96	30	60	1.20	260
WCI 3225-3R9 □-N	3.90	7.96	30	55	1.30	250
WCI 3225-4R7 □-N	4.70	7.96	30	50	1.50	220
WCI 3225-5R6 □-N	5.60	7.96	30	45	1.60	200
WCI 3225-6R8 □-N	6.80	7.96	30	40	1.80	180
WCI 3225-8R2 □-N	8.20	7.96	30	35	2.00	170
WCI 3225-100 □-N	10	2.52	30	30	2.10	150
WCI 3225-120 □-N	12	2.52	30	25	2.50	140
WCI 3225-150 □-N	15	2.52	30	20	2.80	130
WCI 3225-180 □-N	18	2.52	30	20	3.30	120
WCI 3225-220 □-N	22	2.52	30	20	3.70	110
WCI 3225-270 □-N	27	2.52	30	18	5.00	80
WCI 3225-330 □-N	33	2.52	30	17	5.60	70
WCI 3225-390 □-N	39	2.52	30	16	6.40	65
WCI 3225-470 □-N	47	2.52	30	15	7.00	60
WCI 3225-560 □-N	56	2.52	30	13	8.00	55
WCI 3225-680 □-N	68	2.52	30	12	9.00	50
WCI 3225-820 □-N	82	2.52	30	11	10	45
WCI 3225-101 □-N	100	0.796	20	10	10	40
WCI 3225-121 □-N	120	0.796	20	9	11	70
WCI 3225-151 □-N	150	0.796	20	7	15	65
WCI 3225-181 □-N	180	0.796	20	7	17	60
WCI 3225-221 □-N	220	0.796	20	6	21	50
WCI 3225-271 □-N	270	0.796	20	5	28	45
WCI 3225-331 □-N	330	0.796	20	5	34	40



CORE MASTER ENTERPRISE CO., LTD.

<http://www.coremaster.com.tw>