

## UNSHIELDED SMD POWER INDUCTORS / DS TYPE

### FEATURES

- ◆ Designed for the smallest possible size and high performance
- ◆ They are with high energy storage and very low resistance making them the ideal inductors for DC-DC conversion in the following applications
- ◆ DS 1608 used ceramic base with gold-plating
- ◆ Others used LCP plastic base



### APPLICATIONS

- ◆ Portable telephones.
- ◆ Personal computers.
- ◆ DC/DC converters, etc.
- ◆ Other various electronic appliances.

### ORDERING CODE

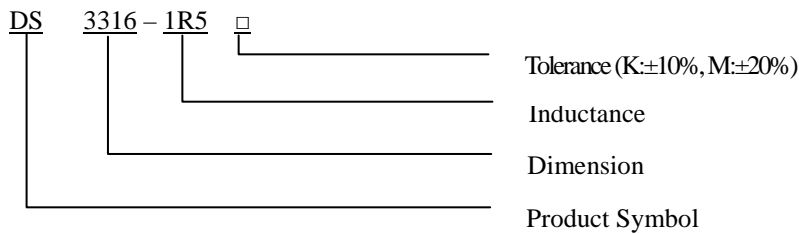

### DIMENSIONS (UNIT: mm)

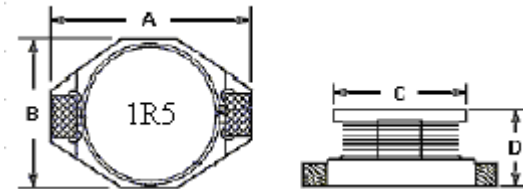

A	12.95 (MAX)	m/m
B	9.40 (MAX)	m/m
C	8.38 (MAX)	m/m
D	5.21 (MAX)	m/m

CORE MASTER ENTERPRISE CO., LTD.

<http://www.coremaster.com.tw>



## UNSHIELDED SMD POWER INDUCTORS / DS TYPE

### ELECTRICAL CHARACTERISTICS FOR DS3316

Part No.	Inductance (uH)	RDC ( $\Omega$ )	IDC (A)
DS3316-1R0 □	1.0	0.007	15.00
DS3316-1R5 □	1.5	0.010	13.00
DS3316-2R2 □	2.2	0.020	12.10
DS3316-3R3 □	3.3	0.021	9.00
DS3316-4R7 □	4.7	0.023	8.00
DS3316-6R8 □	6.8	0.045	6.40
DS3316-100 □	10	0.050	5.60
DS3316-120 □	12	0.062	5.10
DS3316-150 □	15	0.065	5.00
DS3316-180 □	18	0.070	4.00
DS3316-220 □	22	0.085	2.50
DS3316-330 □	33	0.10	2.10
DS3316-470 □	47	0.14	2.00
DS3316-680 □	68	0.20	2.00
DS3316-101 □	100	0.28	1.50
DS3316-151 □	150	0.40	1.40
DS3316-221 □	220	0.61	1.00
DS3316-331 □	330	1.02	0.95
DS3316-471 □	470	1.40	0.50
DS3316-681 □	680	2.00	0.40
DS3316-102 □	1000	3.50	0.30

\* 100uH 以上 Test Frequency : 1KHZ/1V

\* 100uH 以下 Test Frequency : 100KHZ/0.1V



CORE MASTER ENTERPRISE CO., LTD.

<http://www.coremaster.com.tw>