

Capacitor specifications
Application
Reference Standard
Design Ref. no.***
Description

DCL- 23 Metallized Polypropylene Film Capacitors
General use in Power Electronics also for nonsinusoidal voltages and currents
IEC 61071:2007
 DCL-23-050 Rev 00 *** To be mentioned during ordering
 70uF ± 10% 900 Vdc 85 x 40 Terminal - MS

Date 25.01.2018

Customer: Ozdisan

Construction

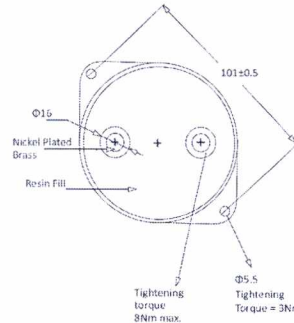
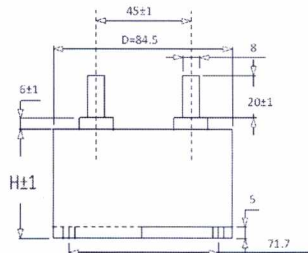
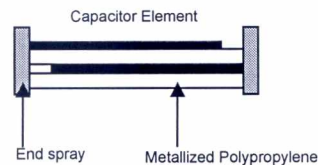

D ± 1 84.5
H ± 1 40.0

Mechanical Characteristics

Enclosure	Plastic enclosure UL94V0	
Terminations	M8X20 mm Male threading	
Internal Protection	No internal fuse	
Encapsulation	Non liquid , No PCB , filled with PU resin	
Fire load	0.025 MJ / KG	
Weight	0.5 KG	
Reliability		
Failure Rate	300FIT	
Reference Life @ $\Theta_{hotspot}$	100,000hrs @ $\leq 50^\circ\text{C}$	
Thermal Conditions		
Lowest operating temp	Θ_{min}	-25°C
Maximum operating temp	Θ_{max}	+75°C
Maximum hotspot temp	Θ_{max}	+85°C
Storage temperature	$\Theta_{storage}$	-25°C to +85°C
Thermal resistance (natural cooled) $R_{TH na}$	Thermal resistance (forced cooled) $R_{TH fc}$	Thermal resistance (forced cooled) $R_{TH fc}$
4.8°C/W	4.2°C/W (0.5m/s)	4.0 °C/W (3m/s)

Electrical Characteristics

Rated Capacitance	C_N	70 μF
Capacitance Tolerance		± 10%
Rated voltage d.c.	U_{NDC}	900V
Repetitive peak Voltage	U_p	1350V
Non-recurrent surge voltage	U_s	1800V
Maximum peak current	I_{pk}	5250A
Maximum surge current	I_s	7.8KA
Maximum current (rms)	I_{max}	85A
Typical ESR (+30%)	E_{sr}	0.85m Ω
Tangent of loss angle	$\tan\delta_0$	0.0002
IR after 2 min with 100Vdc	$C \times \text{MFD}$	5000S
Self-inductance	L_s	<25nH
Routine Test		
Voltage test between terminals 10 secs	U_{TT}	1350Vdc
Voltage test between terminals to case 2 secs	U_{TC}	3300 Vac / 50 Hz

Humidity

Class F :Max. relative humidity 75% annual means , 85% occasional ,95% 30 days /year , condensation not permitted

Mounting

Any position without restrictions

Earthing

Mounting stud to be earthed

Hotspot temperature Vs expected life with respect to % Vrdc

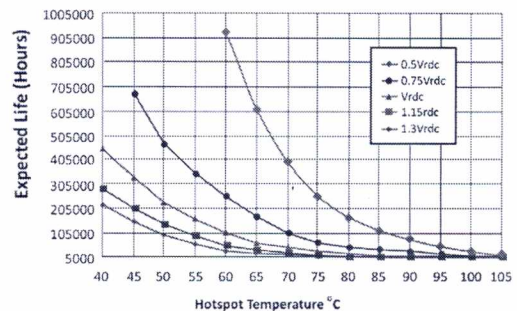

Prepared by *[Signature]*

Checked by *[Signature]*

Approved by *[Signature]*

MASTER COPY

