

Capacitor specifications
Application
Reference Standard
Design Ref. no.***
Description

DCL-41 Metallized Polypropylene Film Capacitors
General use in Power Electronics also for nonsinusoidal voltages and currents
IEC 61071:2007
 DCL-41-041Rev 00 *** To be mentioned during ordering
 470uF ±10% 600Vdc 85 x 140 Terminal - MD

Date 15.09.2014

Construction

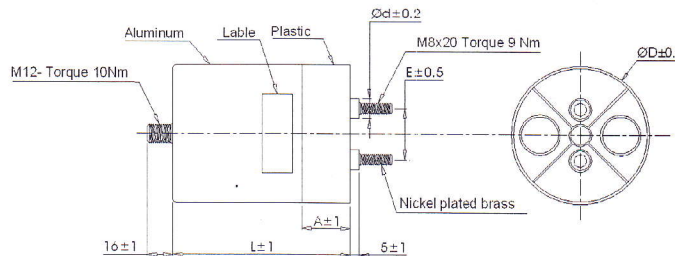
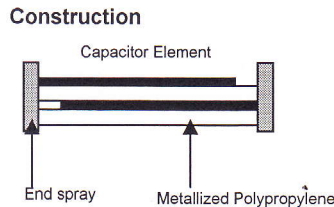

D ± 0.5	85.0
L ± 1	140.0
E ± 0.5	32.0
A ± 1	30.0
d ± 0.2	12.0

Mechanical Characteristics

Enclosure	Aluminum can ,plastic top cover UL94V0
Terminations	M8 male threading
Internal Protection	No internal fuse
Encapsulation	Non liquid , No PCB , filled with PU resin
Fire load	0.025 MJ / KG
Weight	0.71 KG
Reliability	
Failure Rate	300FIT
Reference Life @ $\Theta_{hotspot}$	100,000hrs @ $\leq 70^{\circ}\text{C}$
Thermal Conditions	
Lowest operating temp	Θ_{min} -40°C
Maximum operating temp	Θ_{max} +85°C
Maximum hotspot temp	Θ_{max} +85°C
Storage temperature	$\Theta_{storage}$ -40°C to +85°C
Thermal resistance (natural cooled) $R_{TH na}$	Thermal resistance (forced cooled) $R_{TH fc}$
4.5°C/W	4.1°C/W (0.5m/s) 3.7°C/W (3m/s)

Electrical Characteristics

Rated Capacitance	C_N	470 μF
Capacitance Tolerance		± 10%
Rated voltage d.c.	U_{NDC}	600V
Ripple voltage Max.	U_r	200V
Non-recurrent surge voltage	u_s	900V
Maximum peak current	I_{pk}	2.82 K A
Maximum surge current	I_s	8.46 K A
Maximum current (rms)	I_{max}	40A
Typical ESR (+30%)	$R_s @ 1\text{KHz}$	2.0 m Ω
Tangent of loss angle	$\text{Tan}\delta$	0.001 @ 100Hz
IR after 2 min with 100Vdc	$C \times \text{MFD}$	10000S
Self inductance	L_s	<40nH
Routine Test		
Voltage test between terminals 10 secs	U_{TT}	900Vdc
Voltage test between terminals to case 2 secs	U_{TC}	2700 Vac / 50 Hz

Humidity Class F :Max. relative humidity 75% annual means , 85% occasional ,95% 30 days /year , condensation not permitted
Mounting Any position without restrictions
Earthing Mounting stud to be earthed

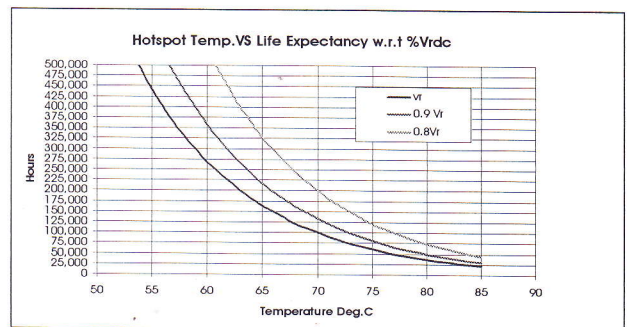

Prepared by *hikind*

Checked by *[Signature]*

Approved by *[Signature]*

MASTER COPY