

EC05E 5mm Size Hollow Shaft Type

Compact type employing Alps' DRUMCODE™ technology

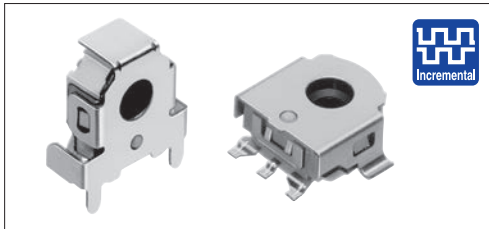

Typical Specifications



Items	Specifications
Rating	0.55mA 5V DC
Operating life	100,000 cycles
Operating temperature range	-30°C to +85°C

Product Line

Detent torque (mN·m)	Number of detent	Number of pulse	Operating direction	Mount height (mm)	Minimum order unit (pcs.)		Product No.	Drawing No.
					Japan	Export		
1.6±1.3	12	12	Horizontal	4.5	4,000	8,000	EC05E1220202	1
			Vertical	—	8,000	16,000	EC05E1220203	2
							EC05E1220401	3

Packing specifications

Taping

Operating direction	Number of packages (pcs.)			Tape width (mm)	Export package measurements (mm)
	1 reel	1 case /Japan	1 case /export packing		
Horizontal	1,000	4,000	8,000	16	410×485×246
Vertical	2,000	8,000	16,000		

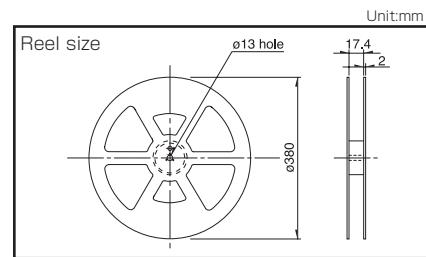

Dimensions

No.	Photo	Style	PC board mounting hole dimensions (Viewed from mounting side)
1		<p>SHAFT HOLE DETAIL</p>	<p>Shaded areas are solder lands.</p>

EC05E 5mm Size Hollow Shaft Type

Dimensions

Unit:mm

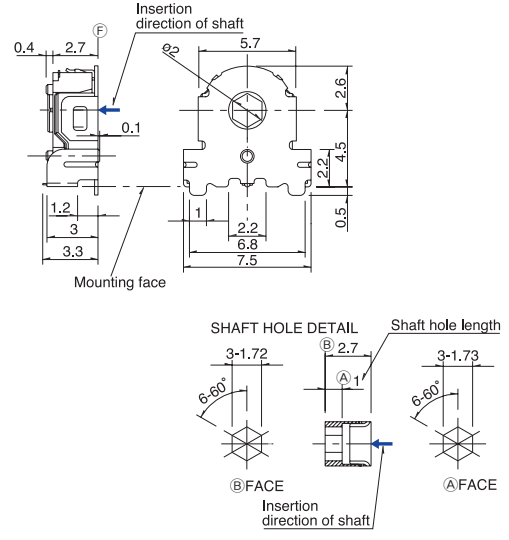
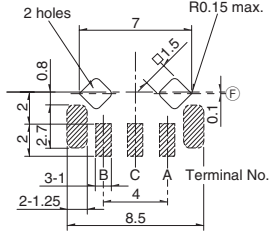
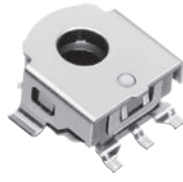
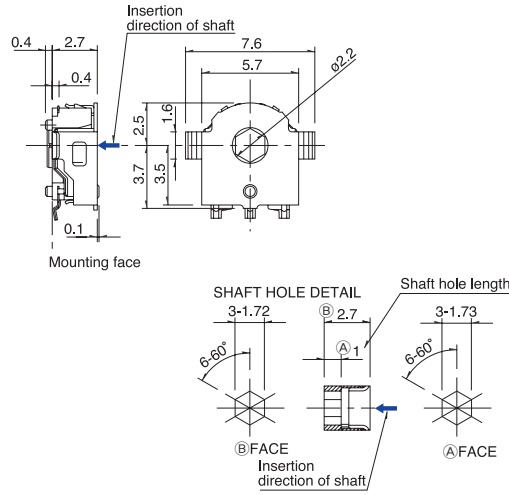
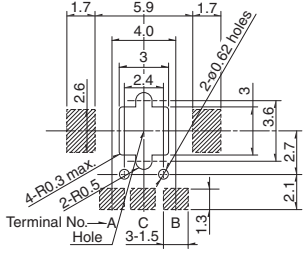
No.	Photo	Style	PC board mounting hole dimensions (Viewed from mounting side)
2			 <p>Shaded areas are solder lands.</p>
3			 <p>Shaded areas are solder lands.</p>

Output Wave

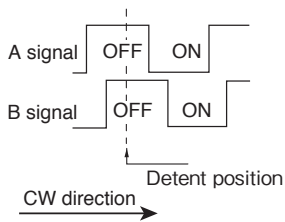







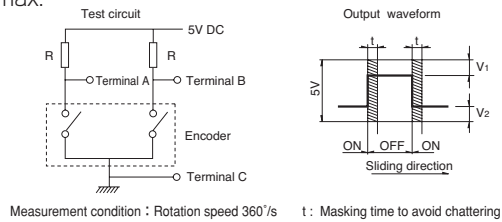

*Signal A and signal B output at detent positions cannot be specified.

Sliding Noise

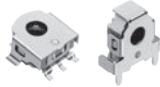
$$V_1 = V_2 = 2.5V \text{ max.}$$



At R = 10k Ω
Chattering : 6ms max. Bounce : 6ms max.

Type		Insulated shaft			Hollow shaft					
		12mm size		18mm size	5mm size		10mm size			
Series		EC12E	EC12D	EC18A	EC05E		EC10E			
Photo										
Output		Incremental (Two phase A and B)			Absolute type		Incremental (Two phase A and B)			
Shaft types		Single-shaft			Hollow shaft					
Operating direction		Vertical			Vertical	Horizontal	Horizontal			
Number of pulse / Number of detent		12 / 12 24 / 24 24 / Without		15 / 30	12 positions 16 positions		12 / 12 12 / 12			
Features		—		With push-on switch	Water resisting performance (IPX7)		Surface mount type			
Dimensions (mm)	W	12.4		12.5	18.8		5.7	7.5		
	D	13.2		11.7	18		6	3.3		
	H	5			8.75		2.7	7.25	10.6 / 12.6 / 14.6	
Operating temperature range		-10°C to +70°C		-40°C to +85°C	-20°C to +60°C		-30°C to +85°C			
Operating life		15,000 cycles 30,000 cycles		30,000 cycles			100,000 cycles			
Automotive use		—		●	—		—			
Life cycle (availability)										
Electrical performance	Rating	0.5mA 5V DC		1mA 5V DC	1mA 10V DC		0.55mA 5.5V DC			
	Max./min. operating current (Resistive load)	5mA / 0.5mA		10mA / 1mA	—		0.55mA / —			
	Insulation resistance	10MΩ min. 50V DC		100MΩ min. 250V DC	10MΩ min. 250V DC		50MΩ min. 50V DC			
	Voltage proof	50V AC for 1 minute		300V AC for 1 minute or 360V AC for 1s	50V AC for 1 minute or 60V AC for 2s		50V AC for 1 minute			
Mechanical performance	Rotational torque (Without detent)	10mN·m max. 25±15mN·m 40±15mN·m		—		—		—		
	Detent torque	3±2mN·m 3 to 20mN·m		5±3mN·m 10±5mN·m		60±20mN·m		1.6±1.3mN·m 5±3mN·m 6±3mN·m		
	Push-pull strength	80N		100N		Push 100N / pull 50N		—		
Shaft configuration		Flat, Hollow Shaft		Flat			Hollow shaft			
Terminal type		Insertion			Reflow		Insertion			
Switch Specifications	Switch type	—		Push-on switch		—		—		
	Contact arrangement	—		Single pole and single throw (Push-on)		—		—		
	Travel (mm)	—		0.5±0.3		—		—		
	Operating force (N)	—		3 ^{+1.5} ₋₁ 6 ^{+2.5} ₋₂		—		—		
	Rating	—		1mA 5V DC (10mA 5V DC max. ratings)		—		—		
	Contact resistance	—		100mΩ max. for initial period; 200mΩ max. after operating life.		—		—		
	Operating life	—		30,000 times		—		—		
Page		293			297		299		301	

Encoders Soldering Conditions 315
 Encoders Cautions 316

Notes

- The operating temperature range for automotive applications can be raised upon request. Please contact us for details.
- Indicates applicability to all products in the series, while ○ indicates applicability to some products in the series.

Reference for Manual Soldering

Series	Tip temperature	Soldering time	No. of solders
EC05E, EC09E, EC10E, EC111, EC11B, EC11E, EC11G, EC11K, EC12D, EC12E, EC18A, EC21A, EC28A, EC35A, EC35AH, EC35B, EC40A, EC45A, EC50A, EC60B, EM11B, EM20B, EC21C, EC28C, EC35CH	350°C max.	3s max.	1 time
EC11J	350±10°C	3 ⁺¹ ₀ s	2 times

Reference for Dip Soldering

Series	Preheating		Dip soldering		No. of solders
	Soldering surface temperature	Heating time	Soldering temperature	Soldering time	
EC09E, EC11B, EC111, EC11E, EC11G, EC11K, EC18A, EC21A, EC28A, EC35A, EC35AH, EC35B, EC50A, EC60B	100°C max.	2 min. max.	260±5°C	5±1s	2 times max.
EC10E, EC12D, EC12E, EM11B	100°C max.	1 min. max.	260±5°C	3±1s	2 times max.
EC40A	110°C max.	1 min. max.	260°C max.	10s max.	1 time
EC45A	100°C max.	2 min. max.	260°C max.	5s max.	2 times max.
EM20B	80°C max.	1 min. max.	260°C max.	3s max.	2 times max.

Example of Reflow Soldering Condition

Temperature profile

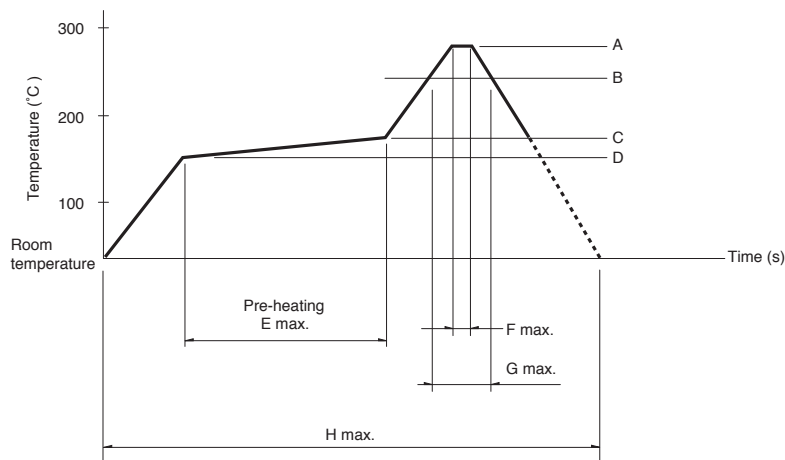

Series	A	B	C	D	E	F	G	H	No. of reflows
EC11J	260°C	230°C	180°C	150°C	2 min. max.	3s	40s	4 min. max.	2 times max.
EC05E	250°C min.	230°C min.	180°C	150°C	60s to 120s	—	30s to 40s	—	2 times max.
EC21C	230°C to 245°C	220°C	200°C	150°C	60s to 120s	—	25s to 60s	300s max.	1 time max.
EC28C, EC35CH	260°C	230°C	180°C	150°C	2 min. min.	3s	40s	230s max.	1 time max.

注記

- When using an infrared reflow oven, solder may sometimes not be applied. Be sure to use a hot air reflow oven or a type that uses infrared rays in combination with hot air.
- The temperatures given above are the maximum temperatures at the terminals of the encoder when employing a hot air reflow method. The temperature of the PC board and the surface temperature of the encoder may vary greatly depending on the PC board material, its size and thickness. Ensure that the surface temperature of the encoder does not rise to 250°C or greater.
- Conditions vary to some extent depending on the type of reflow bath used. Be sure to give due consideration to this prior to use.