

DS Series Tiny Micro Switches



NEW

Extra Tiny



DS030C-00P

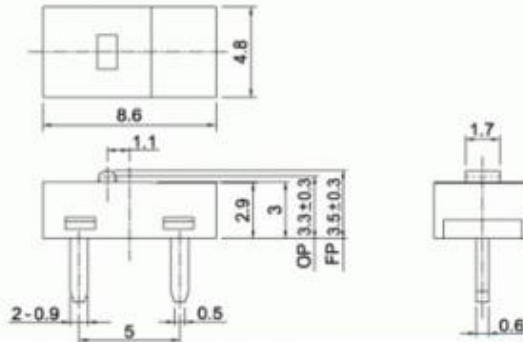

P.C.B. LAYOUT

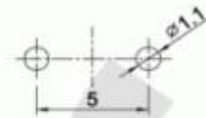

Rating: 0.1A 125V AC / 48V DC.
 Contact resistance: $\leq 300m\Omega$.
 Insulation resistance: $\geq 100M\Omega$ at 250V DC.
 Withstand voltage: 250V AC for 1 minute.
 Mechanical life: 1,000,000 Cycles.
 Electrical life: 1,000,000 Cycles.
 Operating force: 70%g.

NEW



DS030-00P

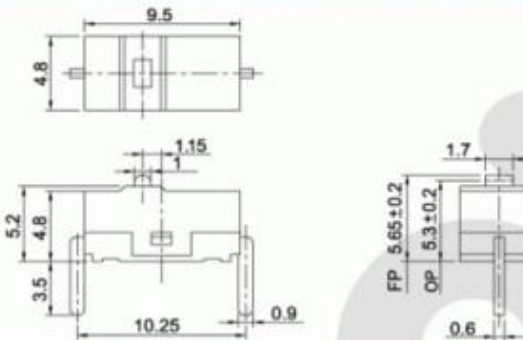

P.C.B. LAYOUT

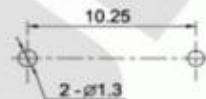

Rating: 0.1A 125V AC / 48V DC.
 Contact resistance: $\leq 300m\Omega$.
 Insulation resistance: $\geq 100M\Omega$ at 250V DC.
 Withstand voltage: 250V AC for 1 minute.
 Mechanical life: 1,000,000 Cycles.
 Electrical life: 1,000,000 Cycles.
 Operating force: 70%g.

NEW



DS130-00M

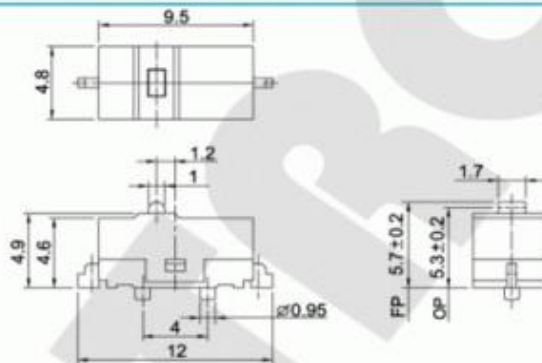

P.C.B. LAYOUT

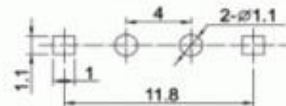

Rating: 0.1A 125V AC / 48V DC.
 Contact resistance: $\leq 300m\Omega$.
 Insulation resistance: $\geq 100M\Omega$ at 250V DC.
 Withstand voltage: 250V AC for 1 minute.
 Mechanical life: 1,000,000 Cycles.
 Electrical life: 1,000,000 Cycles.
 Operating force: 70%g.

NEW



DS030-00C

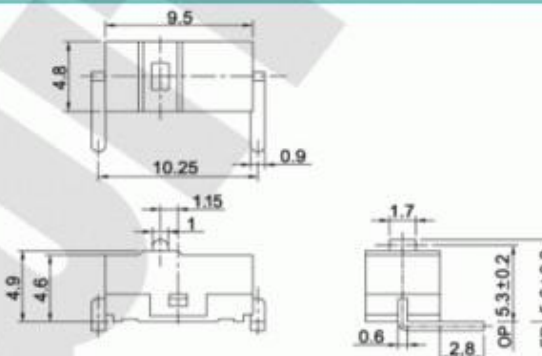

P.C.B. LAYOUT

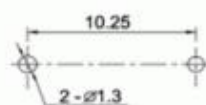

Rating: 0.1A 125V AC / 48V DC.
 Contact resistance: $\leq 300m\Omega$.
 Insulation resistance: $\geq 100M\Omega$ at 250V DC.
 Withstand voltage: 250V AC for 1 minute.
 Mechanical life: 1,000,000 Cycles.
 Electrical life: 1,000,000 Cycles.
 Operating force: 70%g.

NEW



DS030-00D

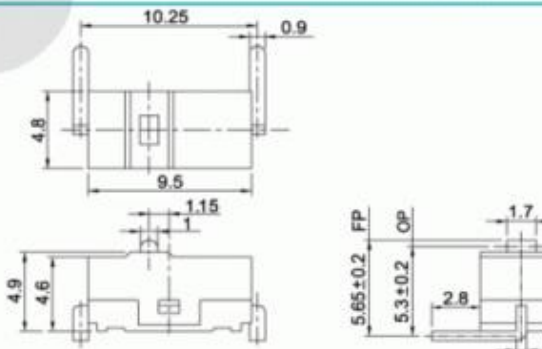

P.C.B. LAYOUT

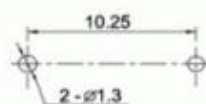

Rating: 0.1A 125V AC / 48V DC.
 Contact resistance: $\leq 300m\Omega$.
 Insulation resistance: $\geq 100M\Omega$ at 250V DC.
 Withstand voltage: 250V AC for 1 minute.
 Mechanical life: 1,000,000 Cycles.
 Electrical life: 1,000,000 Cycles.
 Operating force: 70%g.